

## Tithe Map of Seend 1838

## APPENDIX C

**Source:** Wiltshire and Swindon History Centre  
**Reference:** TA/Seend  
**Scale:** 6 chains to one inch

The Map is signed by Charles Tynne Assistant Tithe Commissioner July 16<sup>th</sup> 1838.

The road to Seend Head Mill and beyond (u/c 6076 and part of Keevil 23) is shown coloured sienna in the same way that public roads are shown.

Although the survey only covers Seend the surveyor has recorded that the route of u/c 6076 continues over Semington Brook and beyond to Keevil.

Routes that were private are shown uncoloured and numbered.

Plot number 844 belongs to Edward Adolphus Seymour, Duke of Somerset and has Samuel Ferris as occupier. It is listed under “sundry houses, cottages, gardens and small plots of ground”.



For a private road, for example 813b, the way is represented as uncoloured and numbered:



The description refers to the “lane to the house”.

The road past Seend Head Mill is shown as a sienna coloured road continuing over the bridge and out of the parish.

The Tithe Map for Seend shows 9 routes leaving the parish, 6 of these are shown coloured sienna and 3 shown uncoloured.

The 9 shown are:

- A361 at Summerham Bridge (A class road)
- Sells Green to Rowde road (C class road)
- Curnick's Lane (SEEN55 to Rowde 21 bridleway)
- Continuation of Broad Lane (SEEN 25 bridleway)
- Collingbourne Lane (SEEN41 to Melksham Without 40 bridleway)
- Colbourne Lane (SEEN 57 to Melksham Without 43 bridleway)
- A365 at Vernon Farm (A class road)
- u/c 6076 to Keevil 23 at Seend Head Mill (u/c road to footpath)
- C class road at Seend Bridge

The modern map shows a further 15 other paths leaving the parish (footpath and bridleway) which are not shown on the Tithe Map.

See below for comparison of Tithe Map representation of the Order route, 2 routes now recorded as bridleways and the A361 at Baldham Bridge all leaving the parish.

**u/c 6076 and Keevil 23 leaving Seend Parish**



**Bridleways Seend 42 and Seend 41 (Broad Lane and Collingbourne Lane) leaving parish**

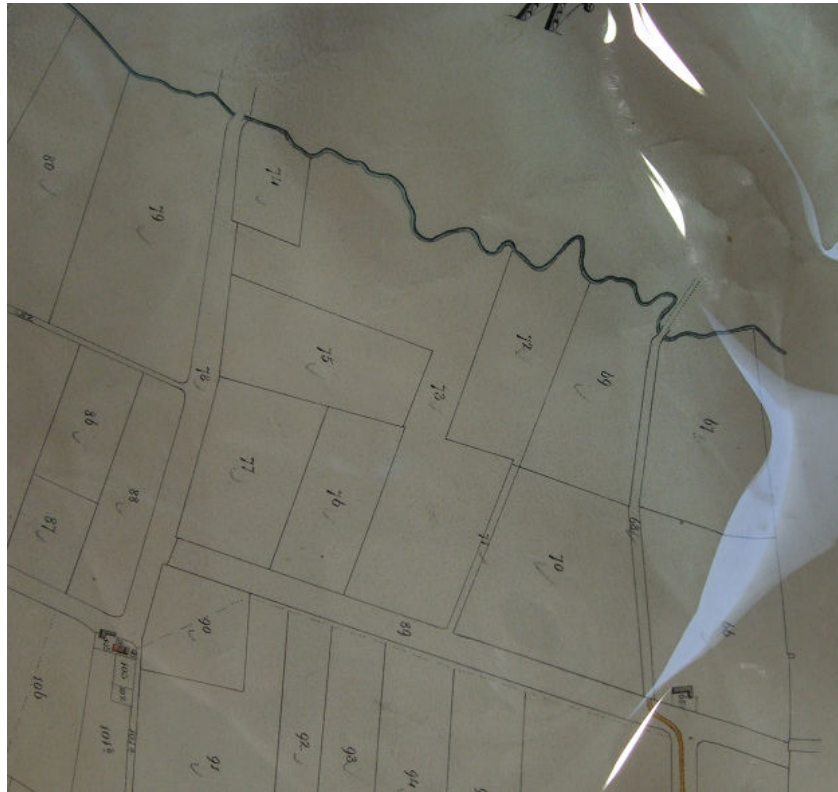

**Seend u/c6076 (LHS) and A361 (RHS) leaving parish**



EXIT POINTS FROM SEEND PARISH TAKEN FROM THE MAP 1838

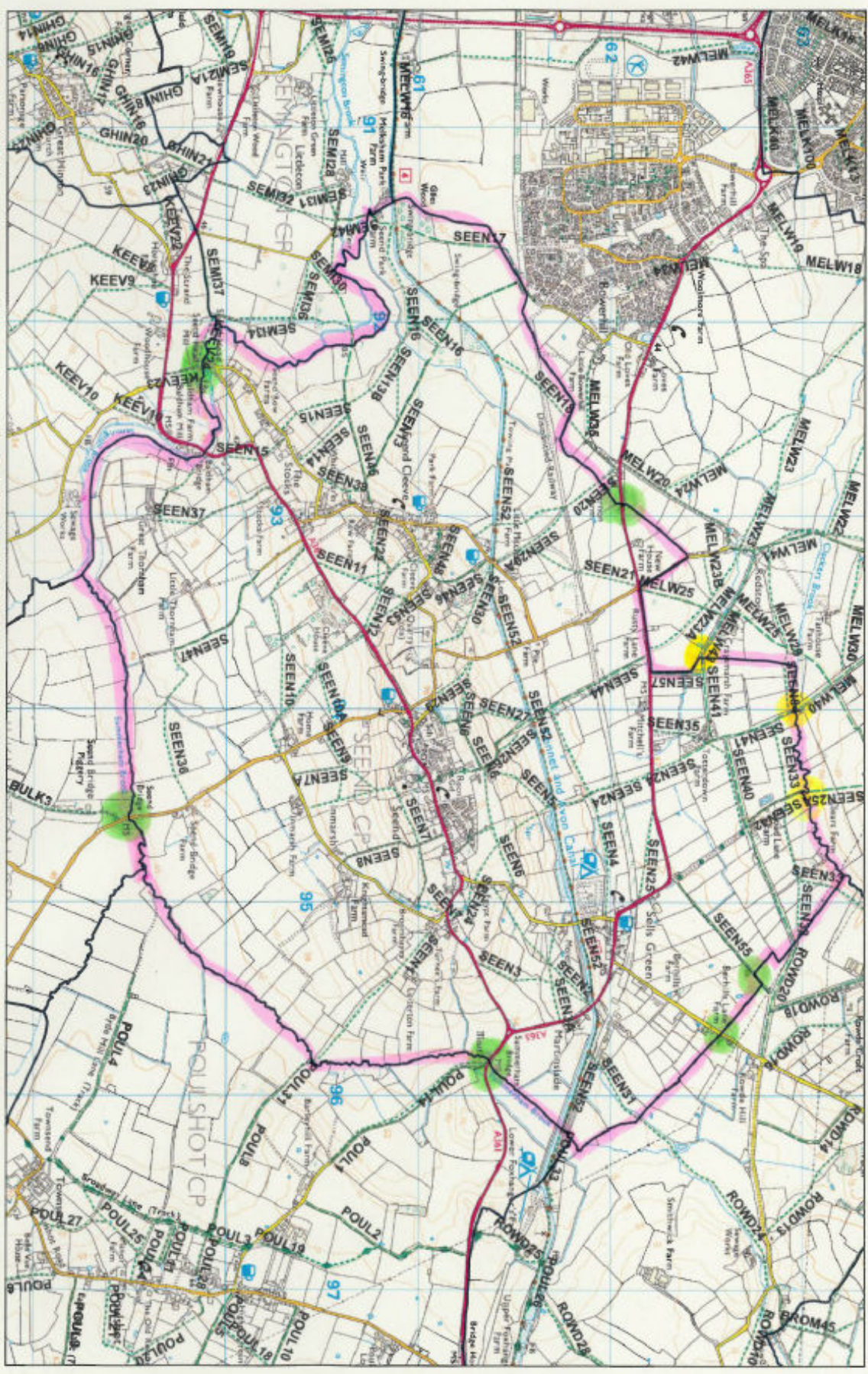

Reproduced from the Ordnance Survey map with the permission of the Controller of Her Majesty's Stationary Office © Crown Copyright 2000.  
 Unauthorised reproduction infringes Crown Copyright and may lead to prosecution or civil proceedings.

Produced using ESRI (UK)'s MapExplorer 2.0 - <http://www.esriuk.com>

Legend:  
 ● Roads shown uncoloured on the map  
 ● Roads shown on the map  
 ● Roads shown uncoloured on the map

Date: 09 January 2009  
 SLA: Not Set  
 Scale: 1:25000